

First Floor

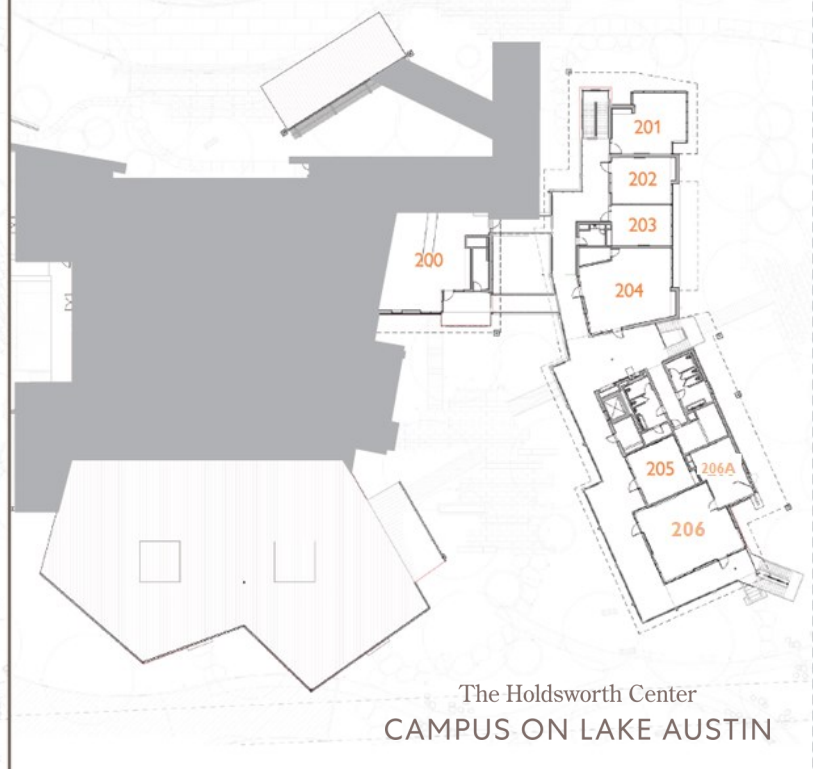

Second Floor



The Holdsworth Center
CAMPUS ON LAKE AUSTIN

Room	Dimensions	Ceiling	Square Feet	Theatre	Classroom	Banquet/ Pods	Conference	Ushape	Reception
Pavilion	51.8' x 126.4'	15'	5068	250	100	250	96	72	250
Pavilion A	51.8' x 57.1'	15'	2194	150	78	130	36	28	145
Pavilion B	51.3' x 69.3'	15'	2874	200	96	170	54	40	190
101	22.6' x 17.7'	12'	371	8	-	-	-	-	10
102/103	24.8' x 33.9'	12'	802	28	16	36	10	12	25
102	24.8' x 18.1'	12'	429	24	6	18	4	7	18
103	24.8' x 15.8'	12'	373	24	6	18	4	6	18
104	38.8' x 30.5'	12'	962	75	14	42	20	14	45
105	20.1' x 23.0'	12'	437	28	12	-	8	10	12
106	18.4' x 23.8'	12'	923	72	9	36	8	12	45
106A	33.4' x 29.1'	12'	360	20	6	8	10	10	10
200	43.4' x 38.8'	12'	1194	72	9	36	8	16	50
201	28.8' x 23.7'	12'	595	-	-	-	18	-	18
202/203	24.8' x 33.9'	12'	802	28	16	36	10	12	25
202	24.8' x 18.1'	12'	429	24	6	18	4	7	18
203	24.8' x 15.9'	12'	374	24	6	18	4	6	18
204	36.8' x 30.6'	12'	951	75	14	42	20	14	45
205	22.1' x 20.9'	15'	428	28	12	-	8	10	12
206	18.7' x 23.8'	12'	919	72	9	36	8	12	45
206A	33.6' x 29.1'	15'	384	20	6	8	10	10	10
Courtyard	43.5' x 95.7'	15'	3095	-	-	60	-	-	60
Amphitheater	27.1' x 51.4'	15'	1153	125/250	-	-	-	-	-
Charlie's Place	37.2' x 59.7'	16'	1427	-	-	-	-	-	50
Dock Classroom	17.5' x 31.5'	10'	553	35	-	30	-	-	30
Upper Dock	22.1' x 36.4'	15'	650	30	-	-	-	-	30